

Diving into Mastery Guidance for Educators

Each activity sheet is split into three sections, diving, deeper and deepest, which are represented by the following icons:



Diving



Deeper



Deepest

These carefully designed activities take your children through a learning journey, initially ensuring they are fluent with the key concept being taught; then applying this to a range of reasoning and problem-solving activities.

These activity cards might not necessarily be used in a linear way. Some children might begin at the 'Deeper' section and in fact, others may 'dive straight in' to the 'Deepest' section if they have already mastered the skill and are applying this to show their depth of understanding.

Need Planning to Complement this Resource?

National Curriculum Aim

Count in multiples of twos, fives and tens.

For more planning resources to support this aim, [click here](#).

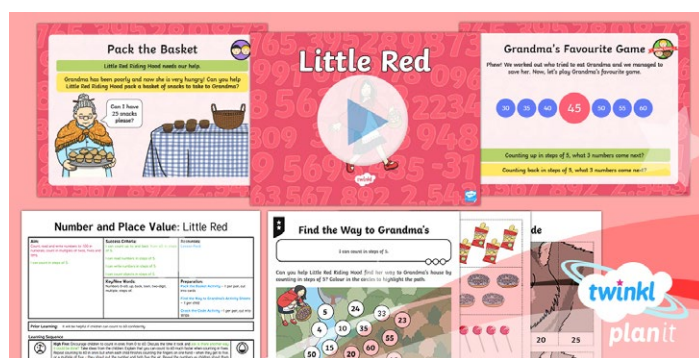
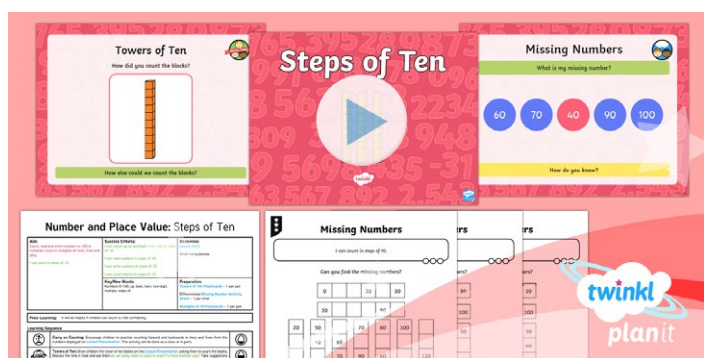

Our PlanIt Maths resources include mastery content, linked Home Learning Packs, excellent extended problem-solving challenges in the form of Solvelts and Challenge Cards. Steps to Progression are also included, this document gives the suggested order to teach the PlanIt Maths lessons and also supports teachers who use the White Rose scheme of learning to make full use of the resources available within PlanIt Maths. Wherever possible, lesson packs have been matched to each of the small steps on the White Rose Maths scheme of learning.

